

Adroit DV51CH

Adroit Line Top Entry -

Up to 170 m³/h air volume @100Pa



KEY FEATURES

- Flow rate up to 47 l/sec (170 m³/h) at 100 Pa
- Up to 84% thermal efficiency and low SFP
- Internet control by smart phone, tablet or PC
- 2 x ISO Coarse > 75% (G4) and 1 x ISO ePM1 50% (F7) filters – complies to ISO 16890
- Full heat recovery for the whole dwelling
- Slim and stylish extractor hood
- Partial bypass function to achieve a suitable supply air temperature
- Optional LCD digital controller with four independent environmental profiles
- Optional built-in electric heater
- Complies with Building Regulations' before 5 year warranty
- Cooker hood available in white and stainless steel
- Fits neatly as part of an integrated solution
- Built-in humidity and carbon dioxide sensors
- 5 year warranty+

Adroit DV51CH

The DV51CH Adroit is a compact kitchen unit incorporating a cooker hood extractor, designed to perfectly combine ventilation and extraction of cooking odours.

The heat recovery unit is delivered with a slim and stylish cooker hood, manufactured from metal providing a fire safe ventilation solution for kitchen installations. The DV51CH Adroit MVHR unit can be easily integrated in the kitchen design as the cooker hood is available in

white or stainless steel. This kitchen ventilation solution is also an efficient use of space in small apartments. The grease filter which protects the MVHR unit against cooking particles can be easily cleaned in soapy water.

A unique feature of the DV51CH Adroit is the benefit of recovering the heat from the hob while other kitchen units discharge directly to outside, skipping the heat recovery process.



SAP RESULTS

Systems with rigid ductwork only SAP 2005 results

Exhaust terminal configuration	Specific Fan Power (W/l/s)	Thermal efficiency (%)
Kitchen+1 additional wet room	0.86	79
Kitchen+2 additional wet room	0.76	80
Kitchen+3 additional wet room	0.80	80
Kitchen+4 additional wet room	0.91	81
Kitchen+5 additional wet room	1.05	81
Kitchen+6 additional wet room	1.22	81

Systems with rigid ductwork only SAP 2012 results

Exhaust terminal configuration	Specific Fan Power (W/l/s)	Thermal efficiency (%)
Kitchen+1 additional wet room	0.78	80
Kitchen+2 additional wet room	0.84	80
Kitchen+3 additional wet room	0.99	81
Kitchen+4 additional wet room	1.24	81

TECHNICAL DATA

Specification	DV51CH (R) Adroit	DV51CH (L) Adroit
Suitable for dwellings up to m ²	75	75
Air flow m ³ /h / l/s @100 Pa	170 / 47	170 / 47
Thermal efficiency	Up to 83%	Up to 83%
Heat exchanger	Counterflow (Aluminium)	Counterflow (Aluminium)
Fans	EC	EC
Summer bypass damper	100% automatic	100% automatic
Frost protection	Stop supply fan	Stop supply fan
Controls	Capacitive buttons with 3 speed profiles (on cooker hood)	Capacitive buttons with 3 speed profiles (on cooker hood)
Digital controls	Optional digital - 4 profiles, 100% adjustable	Optional digital - 4 profiles, 100% adjustable
Mounting	Wall	Wall
Sound level @ 3m (dB(A))	28	28
Duct diameter (mm)	4x125	4x125
Condensate discharge (mm)	12	12
Electrical supply	230 V / 1 ph / 50 Hz	230 V / 1 ph / 50 Hz
Max. power consumption	119 W	119 W
Filter class (ISO 16890)	2 x ISO Coarse > 75% (G4) and 1 x ISO ePM1 50% (F7) filters	2 x ISO Coarse > 75% (G4) and 1 x ISO ePM1 50% (F7) filters
Built-in electric post-heater (optional)	900 W	900 W
Protection class	IP34	IP34
Casing insulation (mm)	10	10
Weight (kg)	66.2 (including cooker hood)	66.2 (including cooker hood)
Dimensions (L x D x H) (mm)	598x349x802 (including cooker hood)	598x349x802 (including cooker hood)
Part No.	90001174 (white) 90001172 (stainless steel)	90001175 (white) 90001173 (stainless steel)

DIMENSIONS

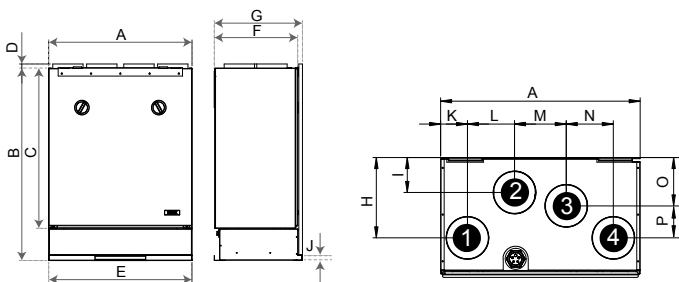

Duct outlets, Model R

Inner diameter of female outlet collar ø125 mm

1. Extract air from the apartment to the unit
2. Supply air from the unit to the apartment
3. Exhaust air flowing outdoors from the unit
4. Outdoor air to the unit

+ excludes motors. Motor warranty one year from date of purchase

Duct outlets, Model L

Inner diameter of female outlet collar ø125 mm

1. Outdoor air to the unit
2. Exhaust air flowing outdoors from the unit
3. Supply air from the unit to the apartment
4. Extract air from the apartment to the unit

Model	A	B	C	D	E	F	G	H	I
DV51CH	598	802	668	17	597	349	368	239	103
	J	K	L	M	N	O	P		
	23	81	141	155	141	143	96		

ACCESSORIES

Visit airflow.com for Adroit controls options data sheet.

PERFORMANCE

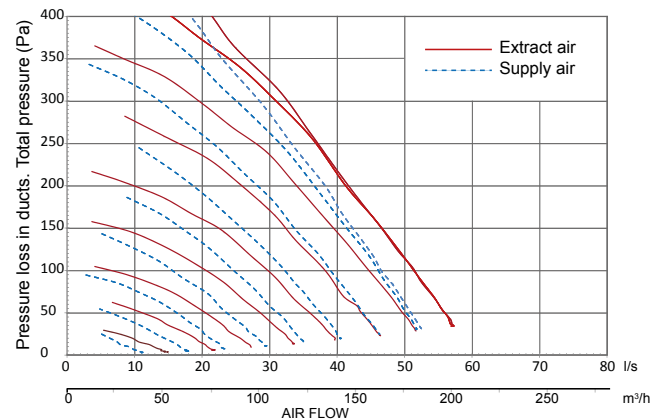

* Guidance only. Dependant upon system pressure.

Accessory	Product Code
Adroit Digital Controller	90000610
Adroit Relative Humidity Transmitter	90000612
Adroit CO ₂ Transmitter	90000613
Adroit Speed Controller	9041219
Additional post heater for DV51CH (R)	90001262
Additional post heater for DV51CH (L)	90001263
2 x ISO Coarse > 75% (G4) and 1 x ISO ePM1 50% (F7) filters	90001264
Boost Switch	90000542
KNX-Converter	90000723



Adroit DV51CH

Adroit Line Top Entry -

Up to 170 m³/h air volume

The DV51CH Adroit is fitted with a triple air filter facility which consists of 2 x ISO Coarse > 75% (G4) and 1 x ISO ePM1 50% (F7) filters – complies to ISO 16890. The air filtration will help prevent small pollen particles from entering indoors.

Adjusting the ventilation characteristics according to specific lifestyles has never been so easy and efficient. Ventilation in a small apartment can be fully controlled through different options of controllers: a switch controller, capacitive touch buttons on the cooker hood front panel, a digital Adroit controller with 4 individual ventilation profiles or via the Internet or a local network using a laptop, smartphone, tablet etc.

The DV51CH Adroit can be integrated within the kitchen units and matched with other kitchen appliances offering an elegant overall style to the entire dwelling. This unit is ideally installed in one- or two-bedroom flats or a small three-bedroom apartment. Saving space and energy, the DV51CH Adroit unit is also easy to maintain and service, having plenty of front space to replace the filters and clean the grease filter grille.

The DV51CH can be integrated with a Building Management System (BMS) via a Modbus connection or KNX, which allows the user to monitor and control the unit's functions via a central control system.

NEW STYLISH AND COMPACT DESIGN

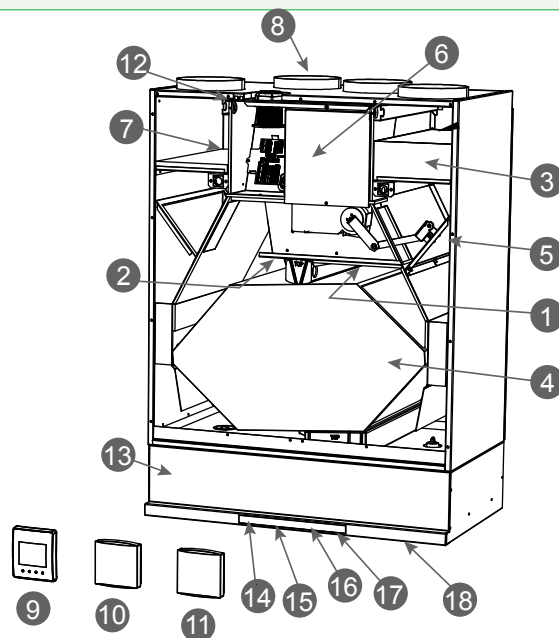

The internal humidity and carbon dioxide sensors ensure automatic boosting of the ventilation unit when required. This function reduces energy consumption even more by having an automated ventilation adjustment.

As previously stated, the unique feature of this MVHR Adroit unit is recovering the heat coming from the hob into the heat exchanger, a total energy class of A+ (when equipped with an additional sensor) is obtained. Another unique feature of this unit is having a partial bypass function. This partial bypass can automatically move into

a suitable position where enough outdoor air is mixed with the supply air to provide the required indoor air temperature.

The DV51CH Adroit cooker hood has a modern and intuitive front panel which blends in with the kitchen furniture design. Two colours are available for the cooker hood: white and stainless steel. In addition, the unit can be customised further by using the brackets provided to hang a matching kitchen unit door. The kitchen door will have the standard width of 600 mm.

- ① Extract fan
- ② Supply fan
- ③ Supply filter
- ④ Heat exchanger
- ⑤ Bypass actuator
- ⑥ Connection box
- ⑦ Extract filter
- ⑧ Post heater
- ⑨ Control panel
- ⑩ CO₂ sensor (optional)

- ⑪ Humidity sensor (optional)
- ⑫ Internal humidity and carbon dioxide sensors
- ⑬ Cooker hood
- ⑭ Damper button
- ⑮ Fan speed buttons
- ⑯ LED light button
- ⑰ Selection button
- ⑱ Grease filter



CONTROLS



Damper's position

The damper is opened by pressing the damper button (light turns on). The damper is closed (light turns off) by pressing the damper button or automatically after one hour (without a timer or 45-120 min when programmed).



Cooker hood light

Turn the light on or off by pressing the light switch. The brightness of the light can be adjusted.



Ventilation profiles

Select the profile by pressing the fan speed button repeatedly until the signal light indicates the desired ventilation profile:



Away profile

Use this ventilation profile when the apartment is unoccupied, e.g. during holiday.



At home profile

Use this ventilation profile when the apartment is occupied.



Boost profile

Use this profile to enhance ventilation, e.g. when there are more people than usual in the apartment.



Selection button

The selection button is used to adjust the brightness of the cooker hood LED.

DV51CH Slim-Line Cooker Hood

Colour options of white or brushed stainless steel



100% AUTOMATIC BYPASS

The unit is equipped with an automatic, 100% bypass which totally isolates the heat exchanger so that no air passes through it. This prevents overheating the dwelling in the summer season.

- **4 ventilation profiles**, 100% adjustable
- **Internet** connection available
- **Automatic boost function** with delay timer
- **Filter maintenance reminder** via counter clock (standard)
- **Heater control** for optional post-heater
- **Connection to BMS** via LON or KNX
- **Self diagnostic** via fault signal relay
- **On-demand control** via humidity and CO₂ sensors
- **Separate fan control** for ease of commissioning
- **Weekly ventilation programming** allows users to pre-set the ventilation levels scheduled for different days
- **Indoor temperature control** based on extract air temperature or supply air temperature
- 100% adjustable speed levels
- User friendly for quick and simple control

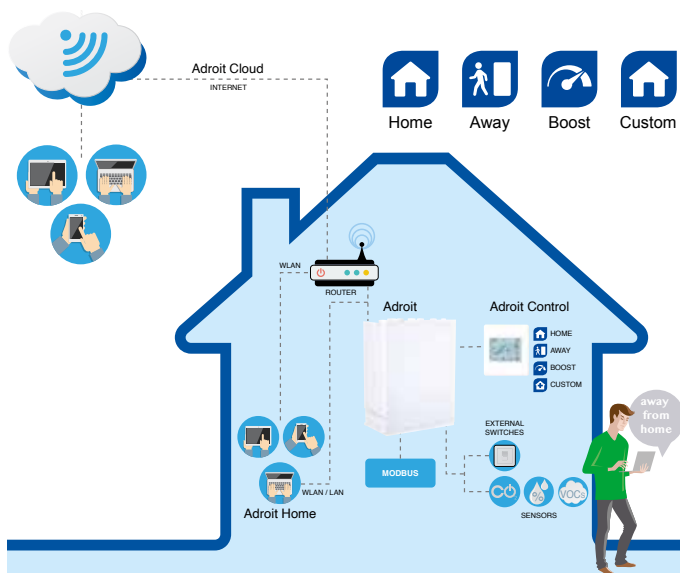

Call: 01494 525252

Visit: airflow.com

AIRFLOW 

Airflow Developments Limited
Aidelle House, Lancaster Road,
Cressex Business Park,
High Wycombe, Buckinghamshire,
United Kingdom, HP12 3QP

E-mail: info@airflow.com
Telephone: +44 (0) 1494 525252

airflow.com

© Airflow Developments Limited. Airflow Developments Limited reserve the right, in the interests of continuous development, to alter specifications without prior notice. All orders are accepted subject to our conditions of sale which are available on request

80000958 - Issue 5 06/23

